

forster fuego light

Sliding systems

forster fuego light

Premium sliding doors

Our multi-functional thermally decoupled system with cooling fire protection fillings for preventive fire and smoke protection indoors. Narrow face widths provide plenty of natural light in the room.

The forster fuego light fire resistant sliding door system with optional smoke protection function for single- and double-leaf doors, with sliding leafs with tight seal on four sides. The fire resistant sliding door can be designed optionally with an integrated escape route function or as a particularly space-saving, quick-opening telescopic version. The barrier-free automatic sliding doors are particularly suitable for use in buildings with high public footfall – such as airports, shopping centres, hospitals or educational institutions.





Standard sliding doors with forster fuego light EI30

The fire protection sliding door for the toughest demands

With an optional sealing level on four sides, the forster fuego light fire protection solution for single and double-leaf sliding doors meets stringent smoke protection requirements and also offers increased airtightness and sound insulation. Due to their large barrier-free openings, the automatic sliding doors can be used in areas with high public footfall.

Your benefits

- Threshold-free and barrier-free
- Smokeproof according to EN 1634-3
- Increased airtightness and sound insulation

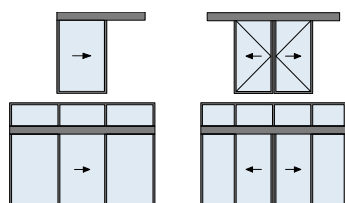

Base detail

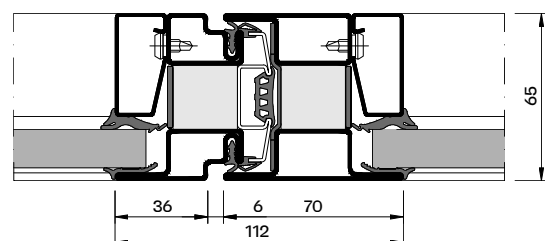
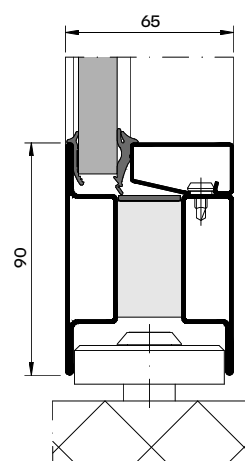

Middle section

Technical specifications

Material variants

Available as CO₂-reduced, low carbon emission steel

Steel zinc magnesium

Brushed stainless steel**

Face widths

Frame from 90 mm

Central section from 112 mm

Dimensions

Inside width single-leaf (W×H): max. 2197 × 3057 mm

Inside width double-leaf (W×H): max. 2600 × 3000 mm

Fittings

Sliding door drive motors from different manufacturers tested and approved

Max. leaf weight according to sliding door drive motor specifications

System features

Design variants:

Sliding door with single/double leaf, with optional sidelight and fanlight

Structural depth 65 mm

Filling element thickness max. 53.5 mm, optionally flush glazing

Steel glazing beads

Wet and dry glazing

Performance characteristics*

Environmental Product Declaration (EPD) according to ISO 14025 and EN 15804

Fire protection:

EI₂30 according to EN 1634-1

EI₂60-90 according to EN 1634-1 as customised solution

Smoke protection: S_a or S₂₀₀ according to EN 1634-3

Durability of self-closing properties: Class 8 according to EN 12400 (tested up to 1 million cycles according to EN 1191)

Finger trapping protection according to DIN 18650 and EN 16005



Barrier-free



Fire resistance



Smoke protection



Low carbon emission steel



Environmental Product Declaration

*Take note of the country-specific approvals and requirements

**On request



Spital Uster, Switzerland
Picture: LOSYS GmbH

Telescopic sliding doors with forster fuego light EI30

More space, more safety

Telescopic sliding doors from the forster fuego light system allow you to create passages with a generous opening width – even in confined installation situations. The fire-retardant EI30 system does not require a continuous floor rail and ensures a smooth flow of people thanks to its automatic opening of up to 50 cm per second. Also suitable for installation in lightweight and solid walls as well as fixed glazing.

Your benefits

- Barrier-free passages
- Fire resistance class EI30
- Filigree design

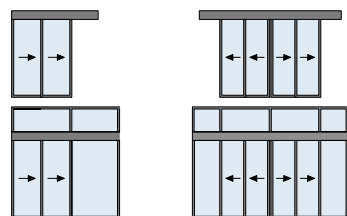

Horizontal section telescopic sliding door

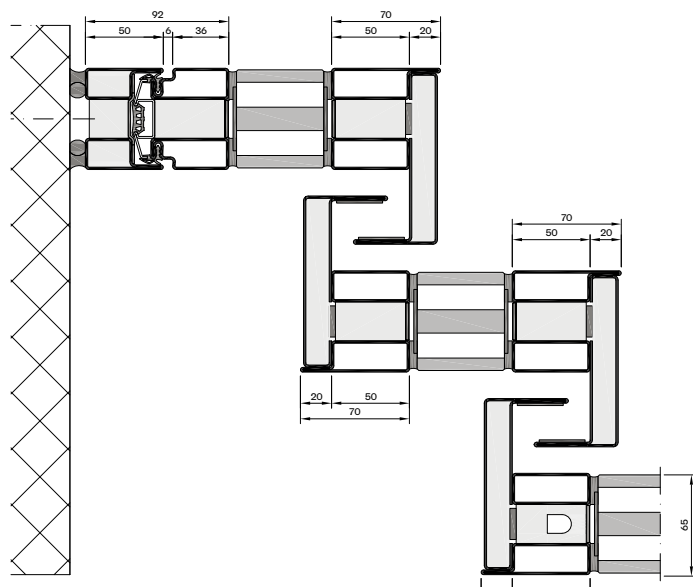

Technical specifications

Material variants

Available as CO₂-reduced, low carbon emission steel

Steel zinc magnesium

Face widths

Frame from 90 mm

Central section from 112 mm

Dimensions

Inside width opening on one side (WxH): max. 2200 × 3000 mm

Inside width opening on both sides (WxH): max. 2622 × 3000 mm

Fittings

Sliding door drive motors from different manufacturers tested and approved

Max. leaf weight according to sliding door drive motor specifications

System features

Design variants:

Sliding door opening on one or both sides, optionally with sidelight and fanlight

Structural depth 65 mm

Filling element thickness max. 53.5 mm, optionally flush glazing

Steel glazing beads

Wet and dry glazing

Performance characteristics*

Environmental Product Declaration (EPD) according to ISO 14025 and EN 15804

Fire protection: EI₂30 according to EN 1634-1

Self-closing: C according to EN 16034

Finger trapping protection according to DIN 18650 and EN 16005



Barrier-free



Fire resistance



Slim profiles



Low carbon emission steel



Environmental Product Declaration

*Take note of the country-specific approvals and requirements



Sliding doors with escape route function with forster fuego light EI30

Sliding doors with sliding and revolving function

Single and double-leaf sliding doors with the forster fuego light system are best suited for public buildings that receive a lot of footfall – such as airports, shopping centres and hospitals. The automatic sliding door utilises two types of opening – sliding and revolving – in one element, thus ensuring that no additional emergency doors have to be budgeted for. The door leaves can be adjusted quickly thanks to the adjustable corners of the leaves.

Your benefits

- Threshold-free and barrier-free
- Escape route according to EN 179 / EN 1125
- Fire resistance class EI30

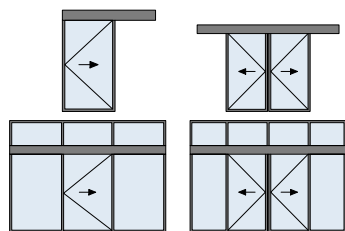

Transition from side panel to sliding sash

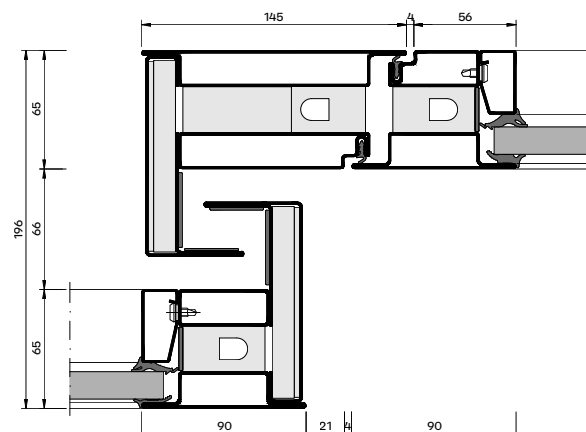

Technical specifications

Material variants

Available as CO₂-reduced, low carbon emission steel

Steel zinc magnesium

Face widths

Frame from 205 mm

Central section from 177 mm

Dimensions

Inside width single-leaf (W×H): max. 1400 × 2500 mm

Inside width associated emergency door (W×H): max. 1240 × 2445 mm

Inside width double-leaf (W×H): max. 2600 × 2500 mm

Inside width associated emergency door (W×H): max. 2490 × 2445 mm

Fittings

Sliding door drive motors from different manufacturers tested and approved

Max. leaf weight according to sliding door drive motor specifications

Fittings for the integrated escape door optionally attached or concealed flush

System features

Design variants:

Sliding door, single/double-leaf with integrated emergency door, optionally with sidelight and fanlight

Integrated emergency doors optionally opening inwards or outwards

Structural depth 65 mm

Filling element thickness max. 53.5 mm, optionally flush glazing

Steel glazing beads

Wet and dry glazing

Performance characteristics*

Environmental Product Declaration (EPD) according to ISO 14025 and EN 15804

Fire protection: EI₂30 according to EN 1634-1

Doors for escape and emergency routes (partial and full panic) according to EN 179 and EN 1125

Finger trapping protection according to DIN 18650 and EN 16005



Barrier-free



Panic function



Fire resistance



Low carbon emission steel



Environmental Product Declaration

*Take note of the country-specific approvals and requirements

EC Avenir, Lausanne, Switzerland
Picture: Damian Poffet



Reference projects with forster fuego light EI30 sliding doors



Zentrum Biffig, Schötz, Switzerland
Picture: Damian Poffet

Geneva Airport, Switzerland
Picture: Damian Poffet





St. Galler Kantonalsbank Halle, St. Gallen, Switzerland
Picture: Thomas Hary

Forster Campus, Romanshorn, Switzerland
Picture: Thomas Hary



Steel is our nature.

For us, steel is a matter of the heart. We develop long-lasting systems for attractive and energy-efficient architecture.

Forster Profile Systems develops and manufactures safe, energy-efficient solutions in steel and stainless steel for doors, windows and facades in Switzerland. Forster works with its own branches in over 20 countries – and exclusive sales partners in around 10 more. In-house consultants are on hand to assist our customers at sites ranging from Europe and the Middle East to Asia and North America. Forster systems are used for building shells and interiors. This includes market-leading solutions that meet

the strictest requirements and standards in terms of thermal insulation, plus safety applications such as fire protection, burglar resistance and bullet resistance. The product range is rounded off by matching accessories. Our customers and business partners in architecture, planning and construction can also count on comprehensive services for their respective industry.

Forster Profilsysteme AG | CH-8590 Romanshorn
info@forstersystems.com | forstersystems.com

forster