

**Non-rebated and non-latched single action door (NR)
EI30 / EI60**

Steel or Stainless steel

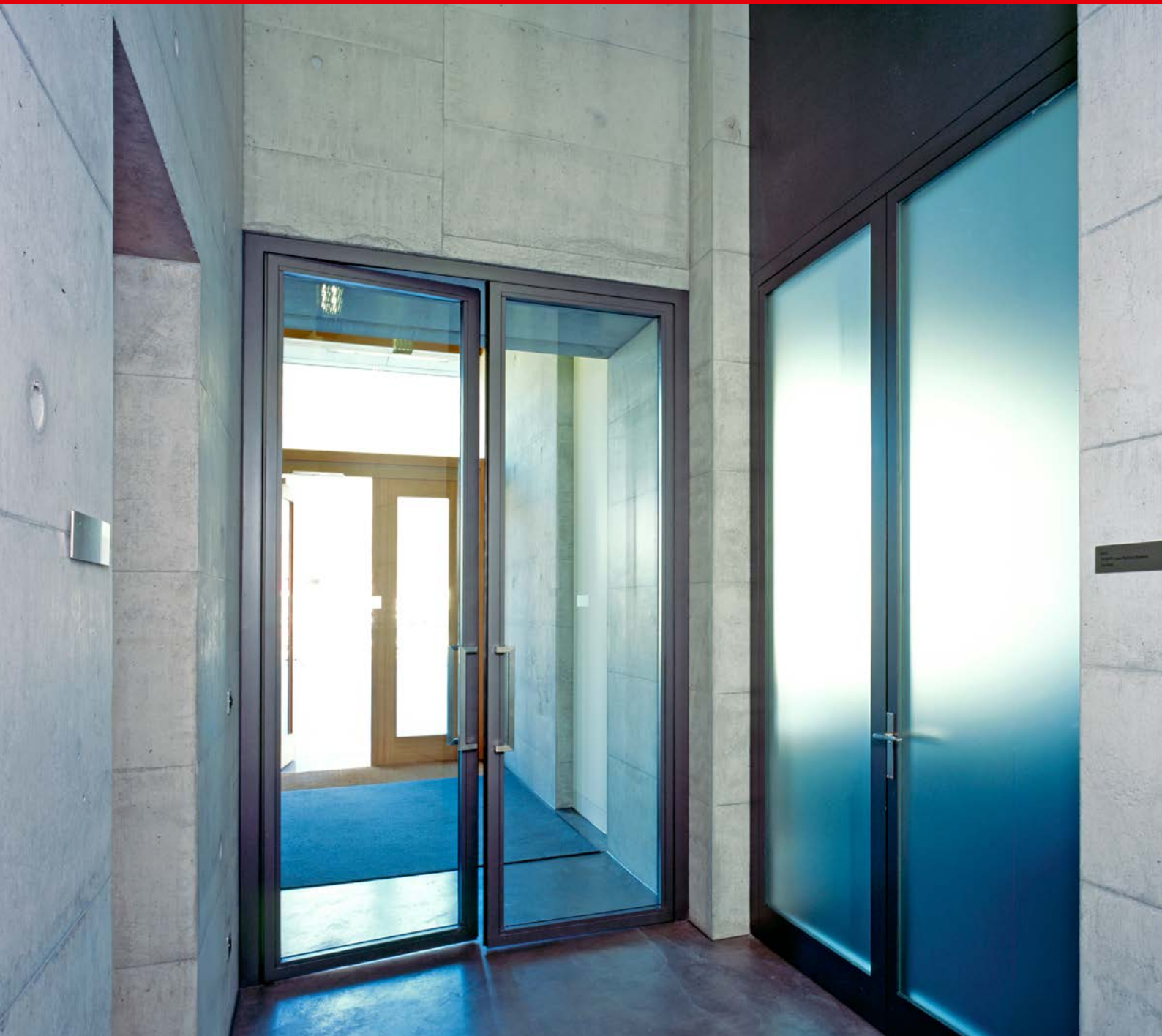

EI30/60

Steel

Stainless steel

UK

2

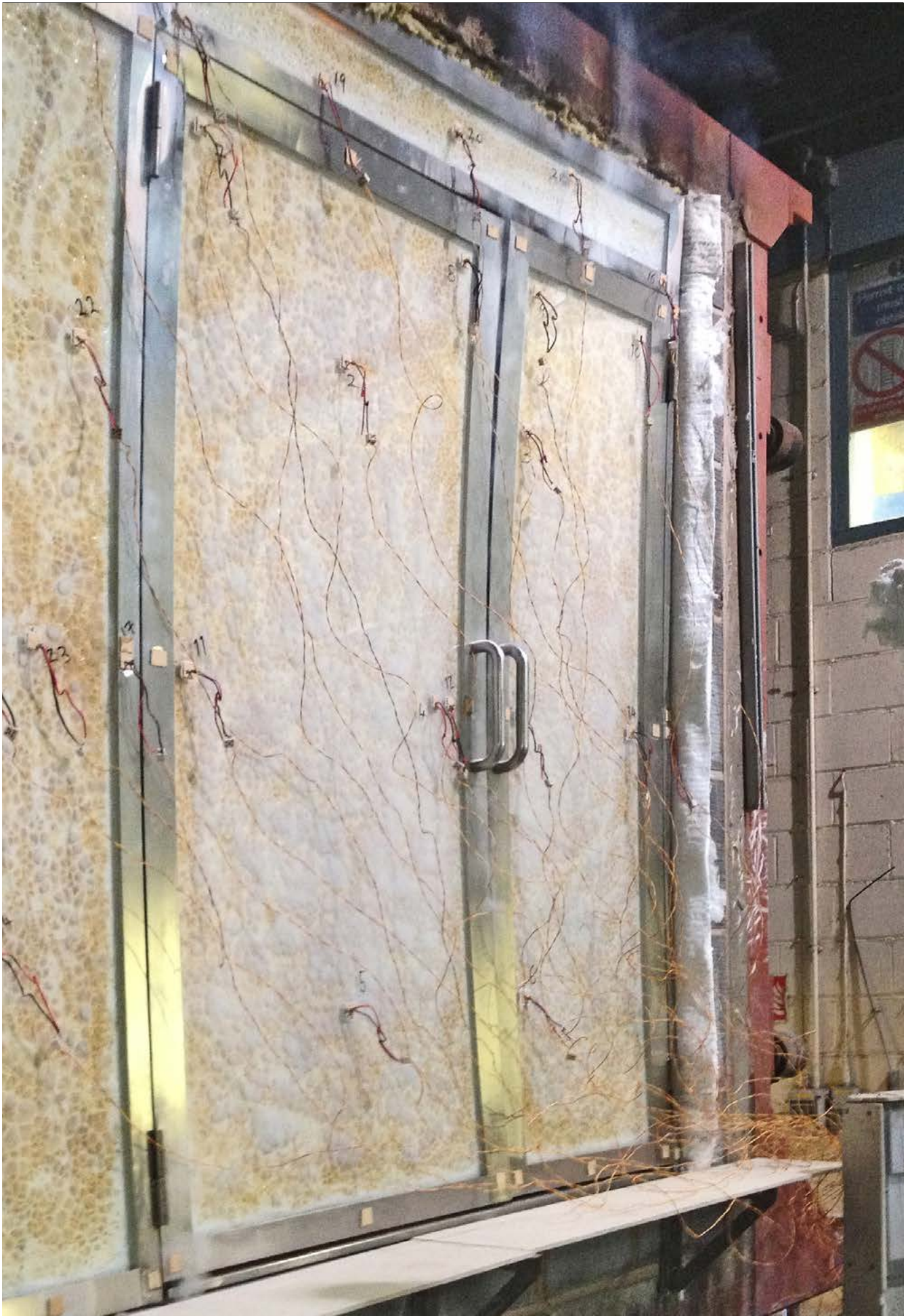

10/16

Index

Description	Page
System information	4
Accessories	5
System plans	6 - 9
System sections	10 - 13
Installation sealing set	14 - 17
General advice	18

Design variants

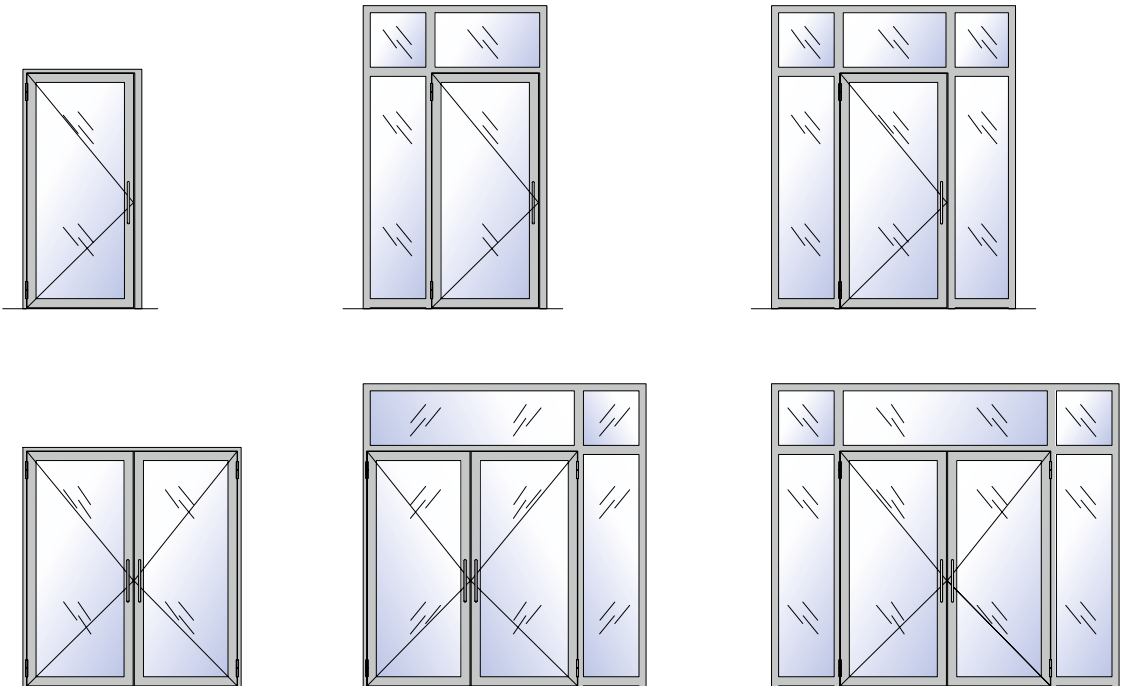

The system

Non-rebated and non locking barrier free access

The system addition of the proven profile system Forster fuego light NR allows to produce flush-fitting single- and double-leaf fire resistant single action doors EI30 and EI60 in steel and stainless steel.

Decisive advantages

High degree of aesthetic appeal

- Thanks to extremely slender visible section widths and individual surface treatment

Performance

- Tested and approved for fire resistance EI30 and EI60 (BS EN 1634-1: 2008)
- Max door leaf size 2450 mm high x 1180 mm wide
- Smoke control tested to EN 1634-3 Sa cold smoke
- Satisfy the most stringent requirements with regard to extreme constant stress
- For highly frequented doors such as those in buildings with heavy pedestrian traffic (e.g. shopping centers, hospitals, schools, airports)

Locks and fittings

- Fittings to match the system
- Dorma surface mounted closers with added functionality of concealed espagnolette locks if required

Processing

- Extremely economical manufacture, no special equipment needed

NR Single action door

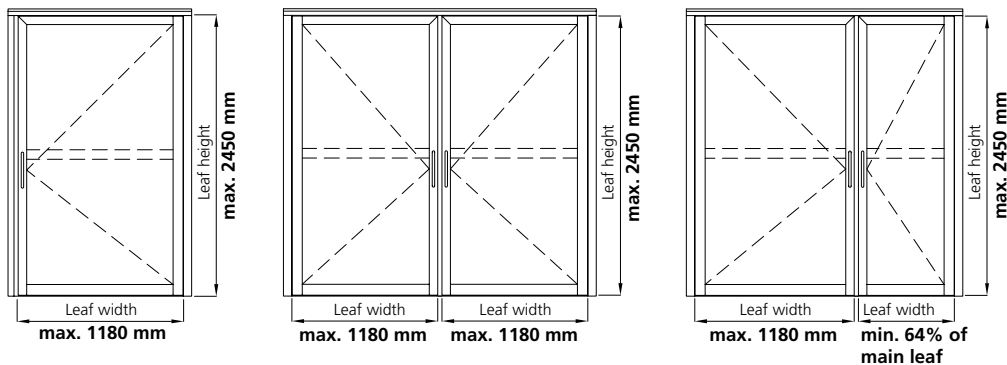

Structure

Single action hinged door, opening outwards or inwards

- Leaf profiles 736.803/T, 736.805/T on hinge side (1 glazing bead)

Glazing

- EI30:
Pilkington Pyrostop 15 mm EI30
- EI60:
Pilkington Pyrostop 23 mm EI60
Vetrotech Contraflam 60-3 EI60

Approved fittings

- Without lock (espagnolette lock available if required)
- Dorma doorcloser

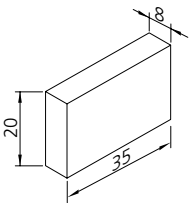
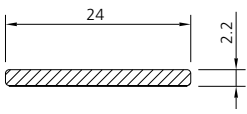
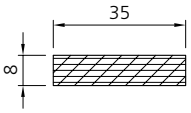
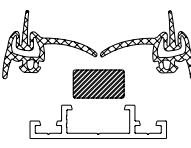

Accessories

Figure	Designation	Sales unit	art. no.
 <p>1</p>	<p>Welding plates set</p> <p>Steel Stainless steel</p>	<p>16 pcs 16 pcs</p>	<p>907019 907020</p>
 <p>2</p>	<p>Intumescent strip (black)</p> <p>Use door rebate incl. fixing screws (900141) 50 pcs</p>	<p>15 m</p>	<p>948002</p>
 <p>3</p>	<p>Insulation set</p> <p>L = 1250 mm</p>	<p>4 pcs</p>	<p>903010</p>
 <p>4</p>	<p>Sealing set 1 + 2 leaf doors</p> <p>Seal for double action door Intumescent strip 14.5 mm Aluminium profile</p>	<p>4 × 3050 mm 4 × 1600 mm 2 × 3050 mm</p>	<p>1 pce 915409</p>

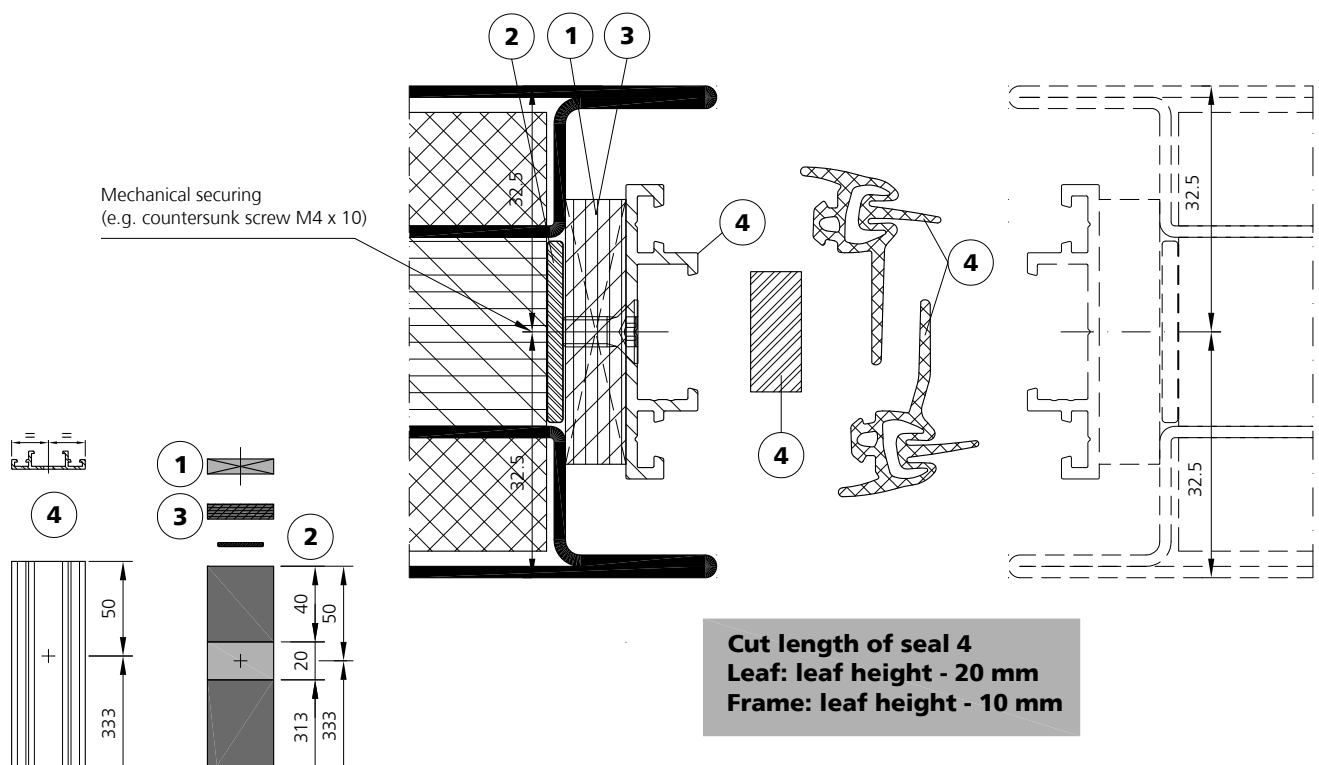



EI30

Steel

Stainless steel

UK

6

**System plan
NR Single action hinged door
EI30**

A - A

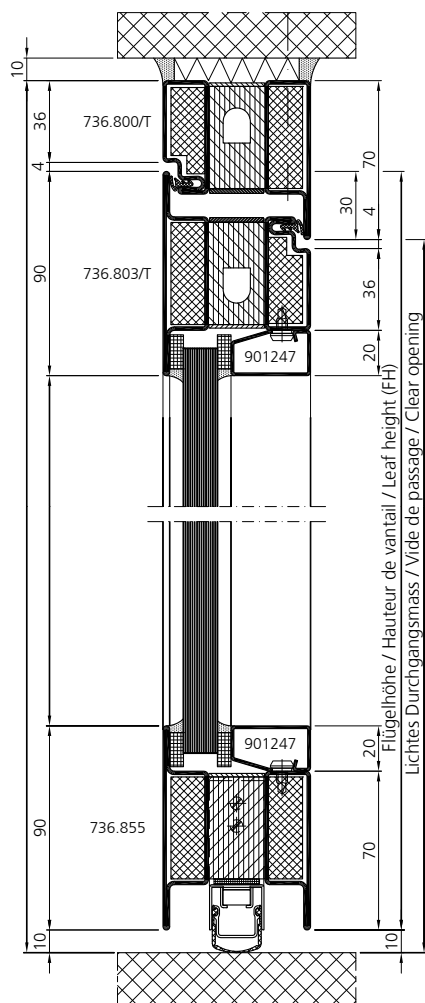

C - C

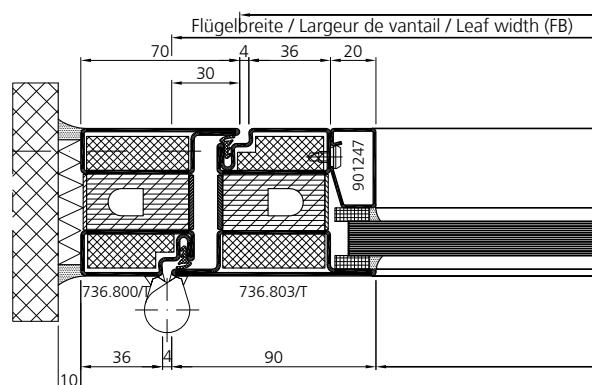

10/16



System plan
NR Single action hinged door
EI30

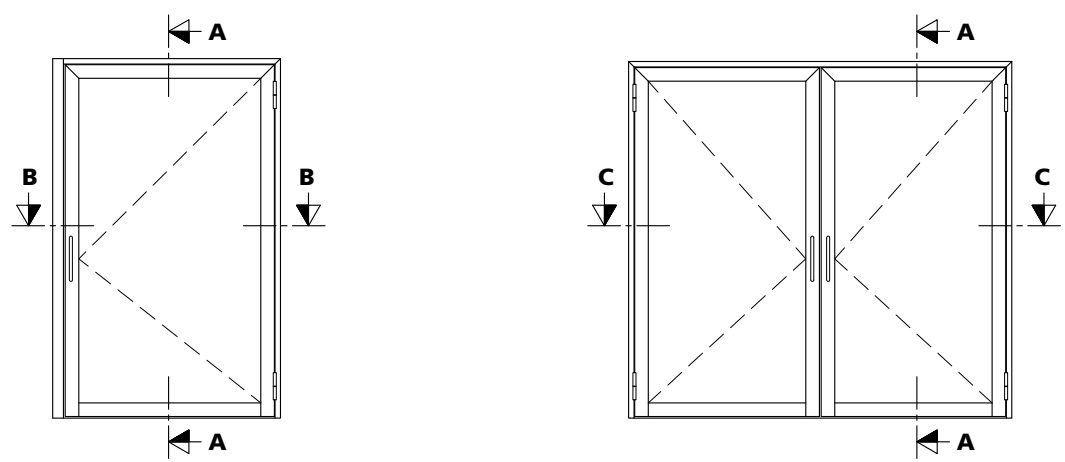

B - B

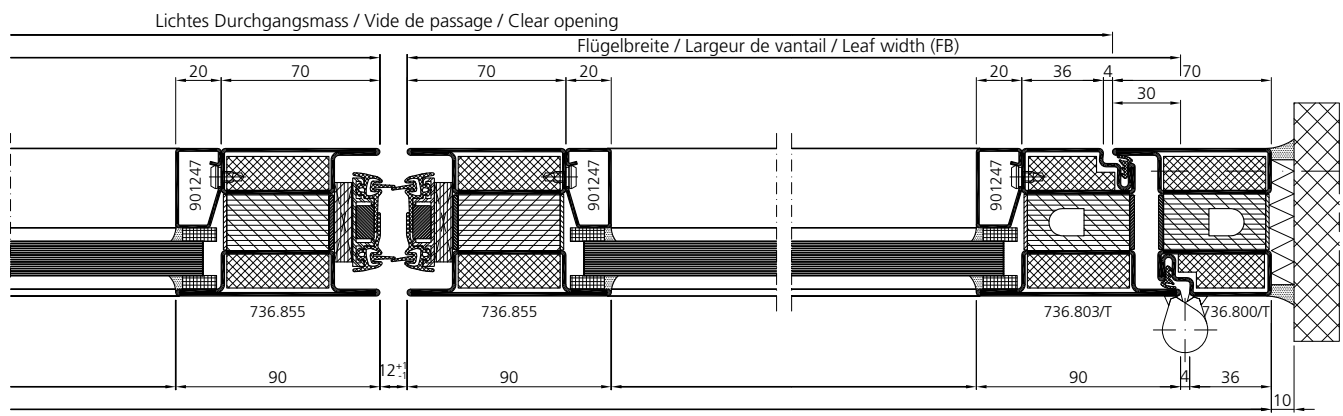
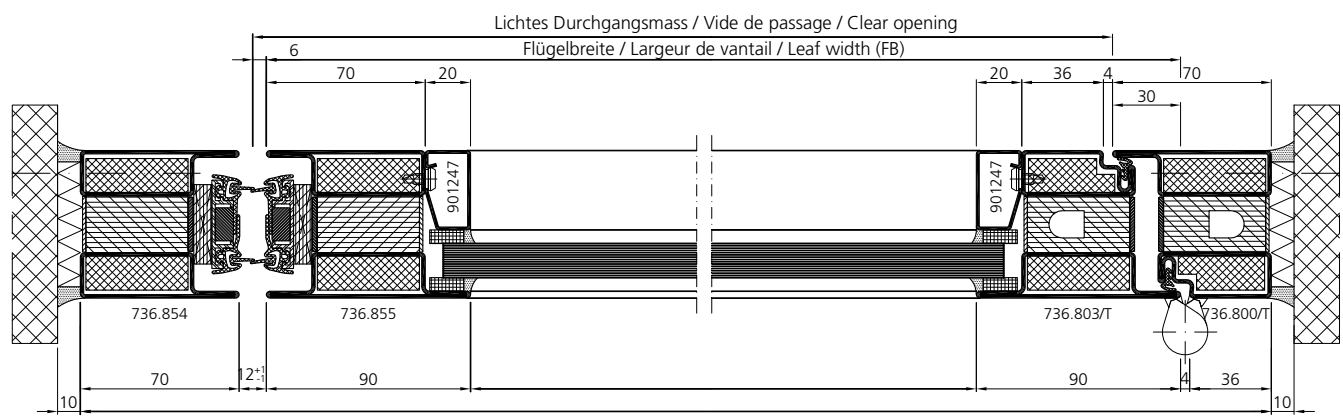



EI60

Steel

Stainless steel

UK

8

**System plan
NR Single action hinged door
EI60**

A - A

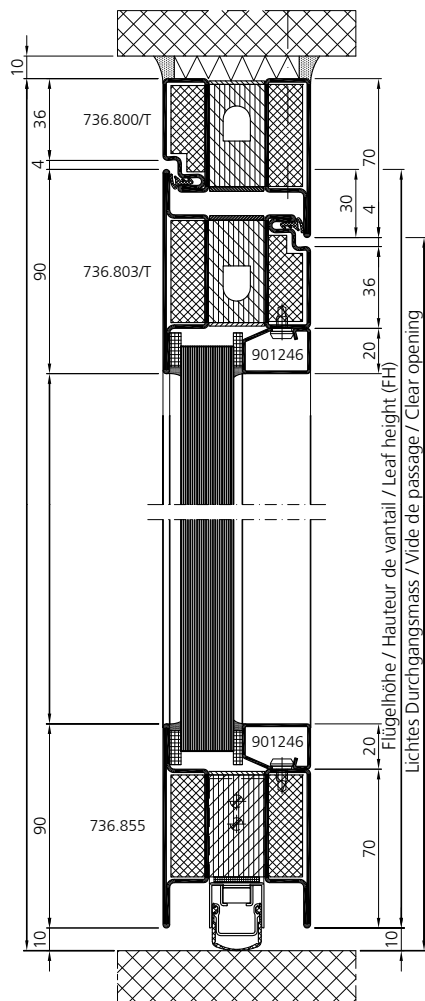

C - C

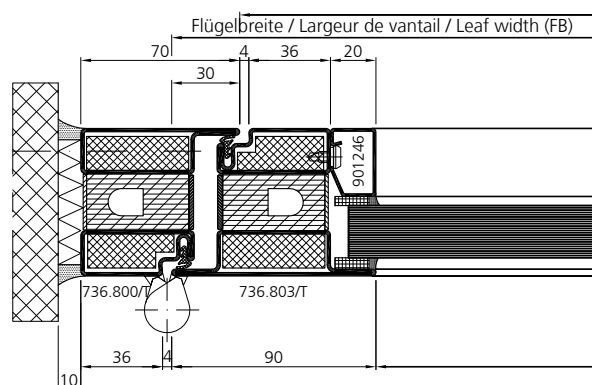



UK

EI60 Steel Stainless steel

**System plan
NR Single action hinged door
EI60**

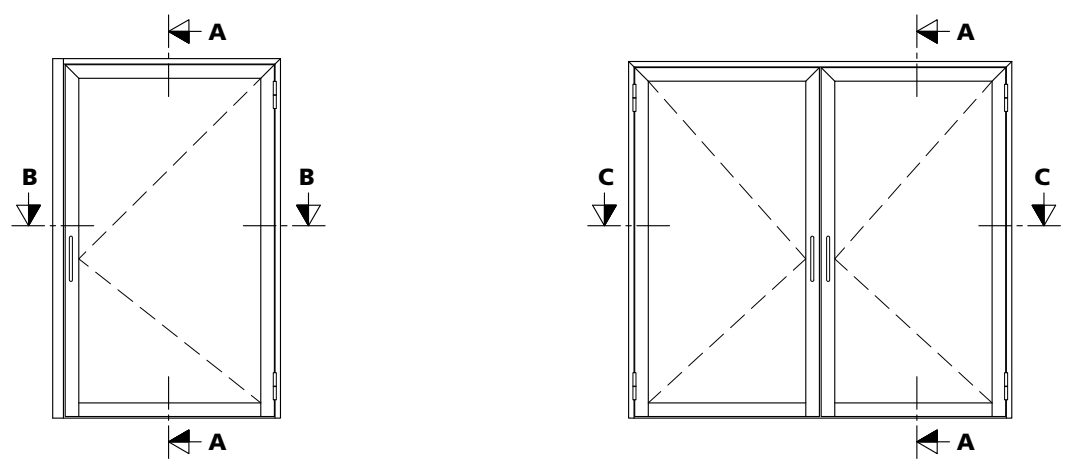

B - B

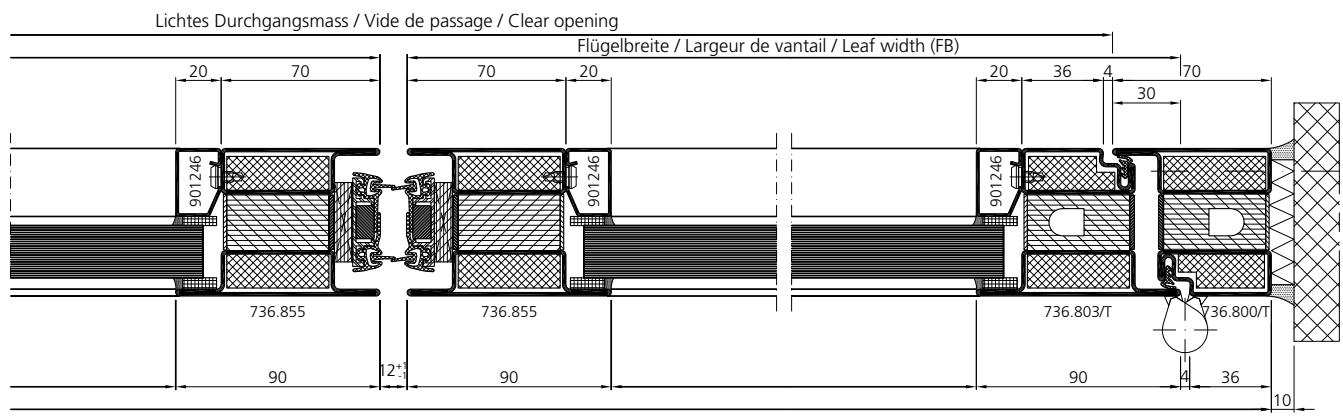
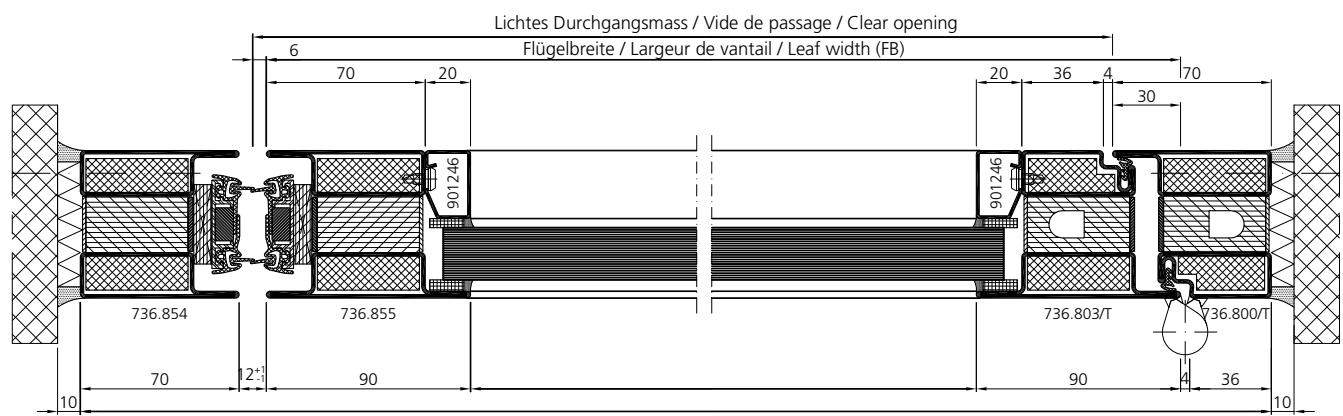



EI30

Steel

Stainless steel

UK

10

**System sections
NR Single action hinged door
Opening outwards - EI30**

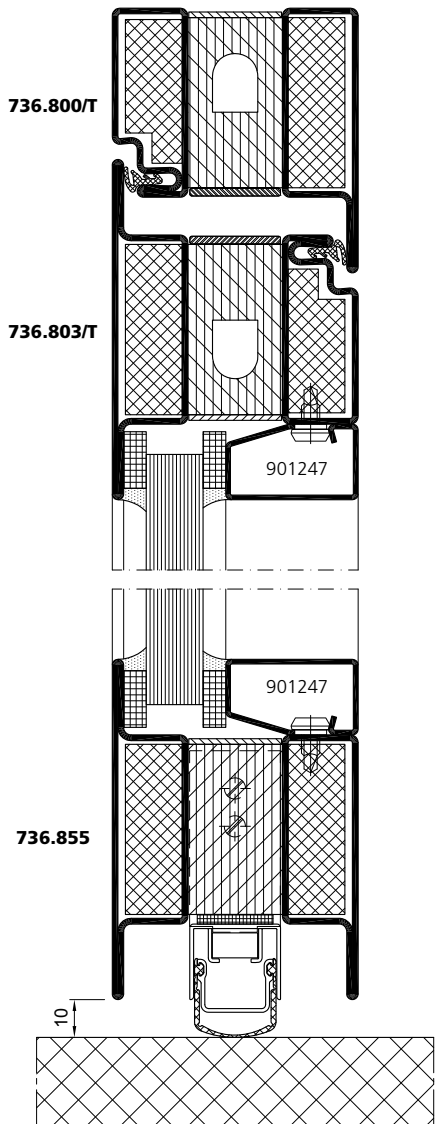
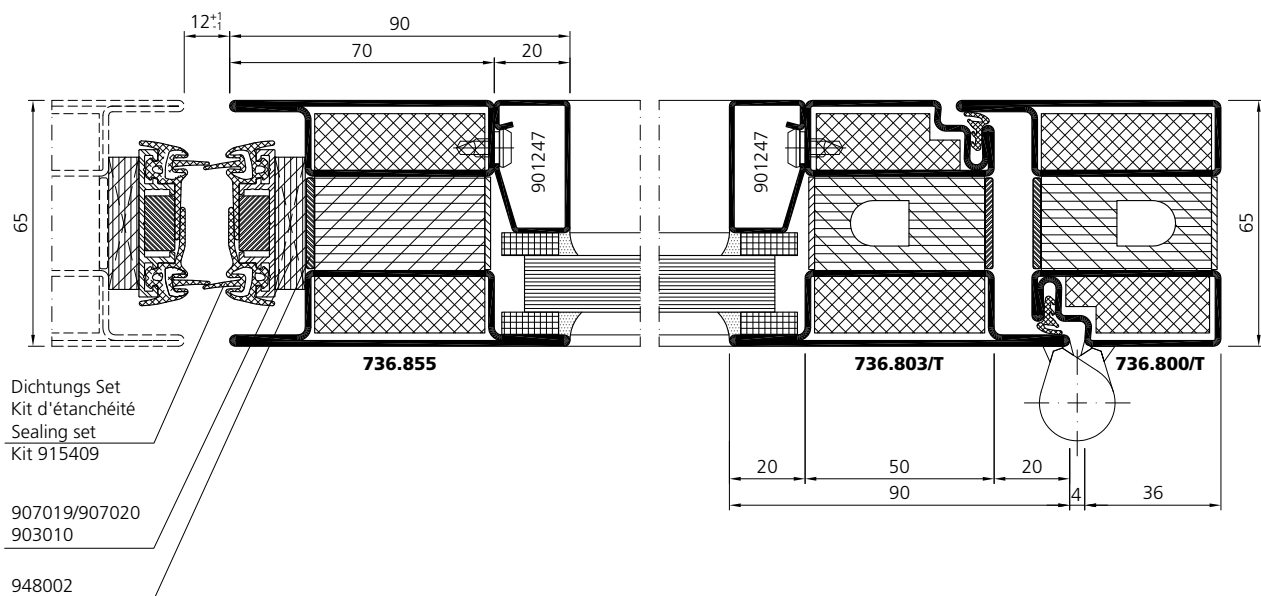

10/16



System sections
NR Single action hinged door
Opening inwards – EI30

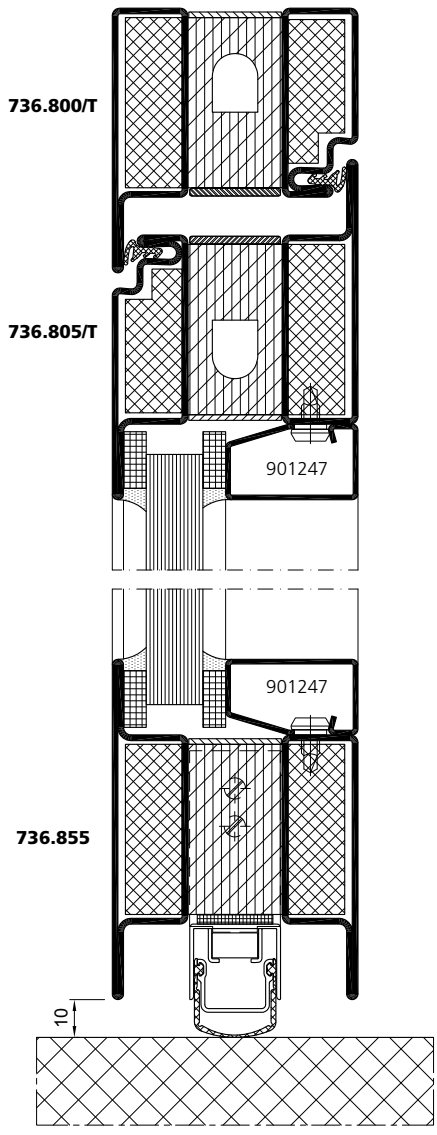
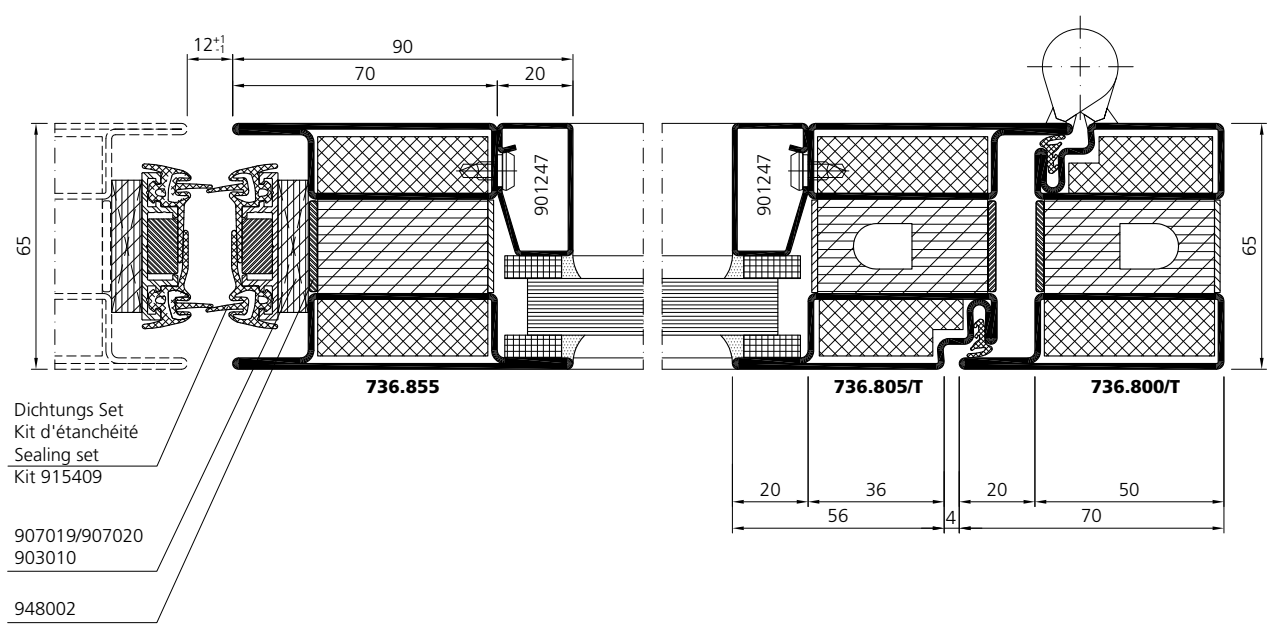



EI60

Steel

Stainless steel

UK

12

**System sections
NR Single action hinged door
Opening outwards - EI60**

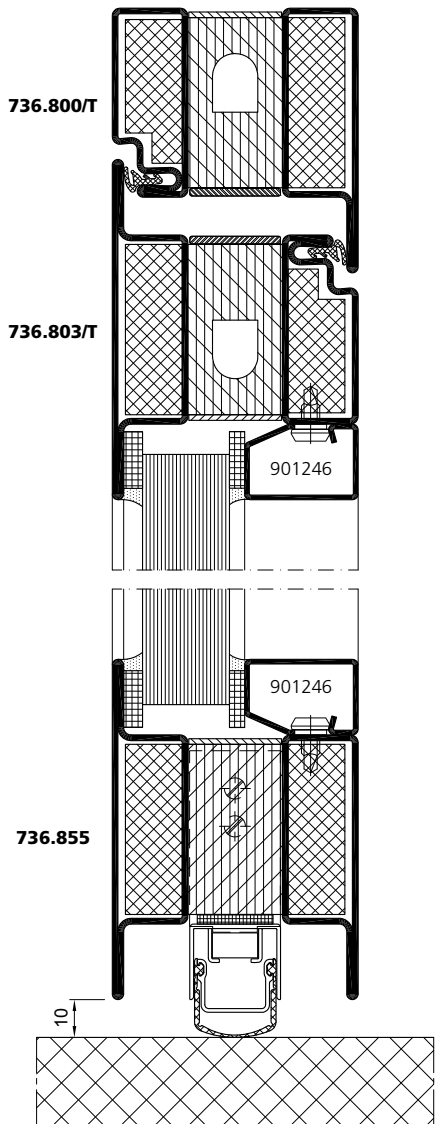
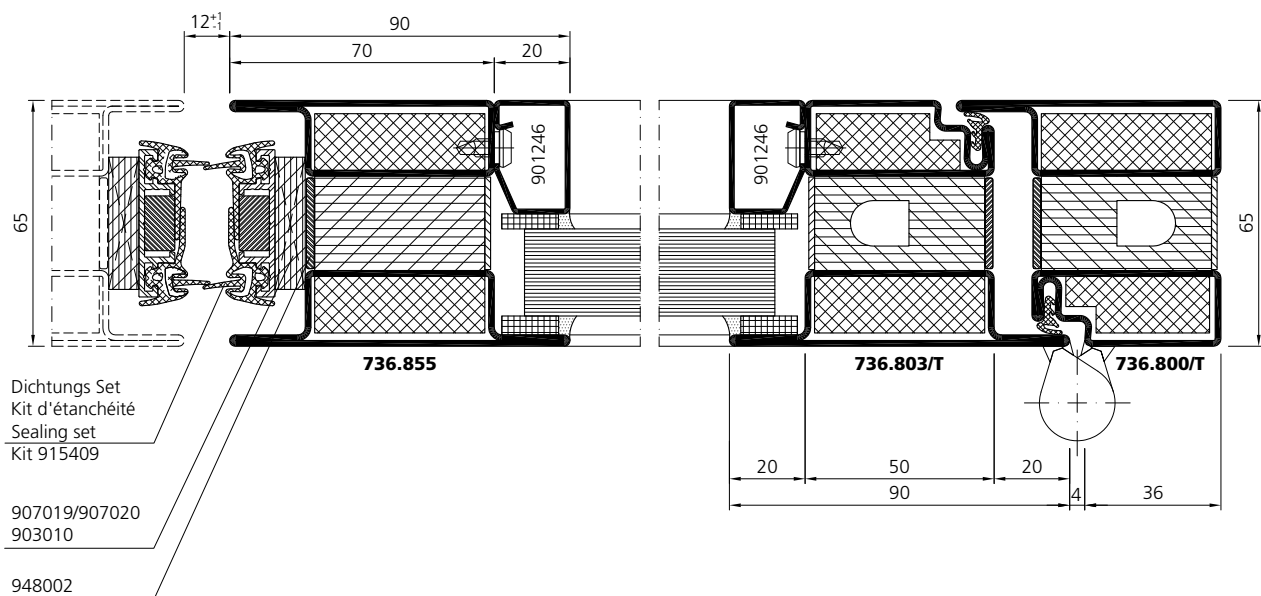

10/16



System sections
NR Single action hinged door
Opening inwards - EI60

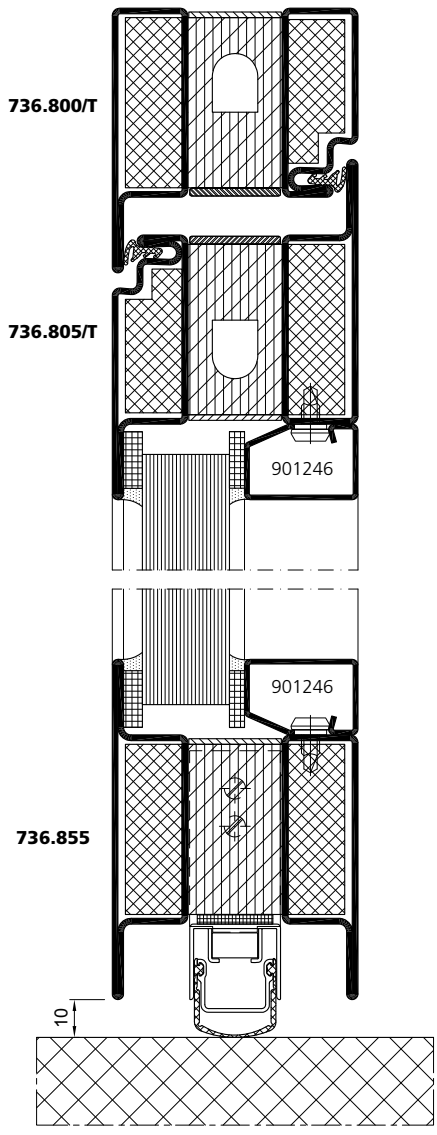
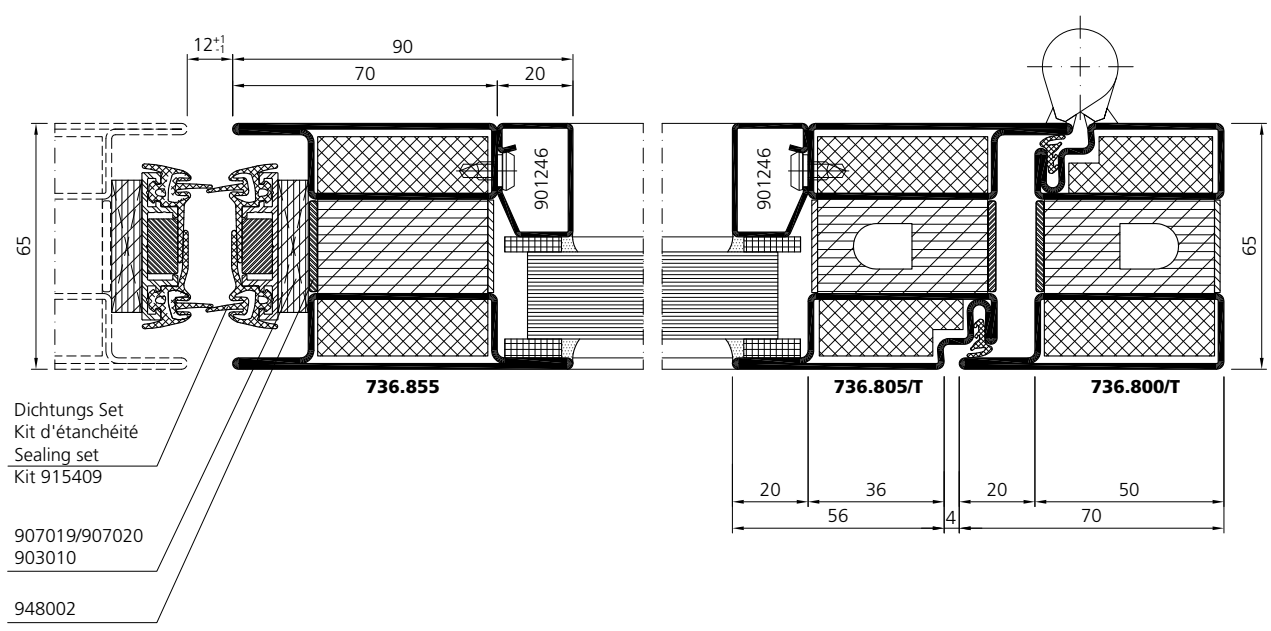

Installation of sealing set NR Single action door

1

Tack-weld plates 907019/907020 to the top & bottom of the leaf edges, a maximum of 8 plates are required for a door leaf of 2450 mm high.

The top & bottom plates are fitted 50 mm in from the top & bottom edges of the door leaf to the centre of the plate with the remaining plates equi spaced at no more than 333 mm centres.

2

After painting doors fix intumescent strips 948002 between the plates in accordance with the instructions.

3

Bond & pin insulating boarding 903010 over 948002 intumescent strips & between plates.

4

Screw fix the AFT aluminium holder to the plates using M4 machine screws & fix intumescent pack & AFT gasket to holder.

Ensure gap at meeting stile edges are 12 mm for both double and single door applications.

For smoke control NR door add fire rated silicone as shown prior to fitting the rubber gaskets:

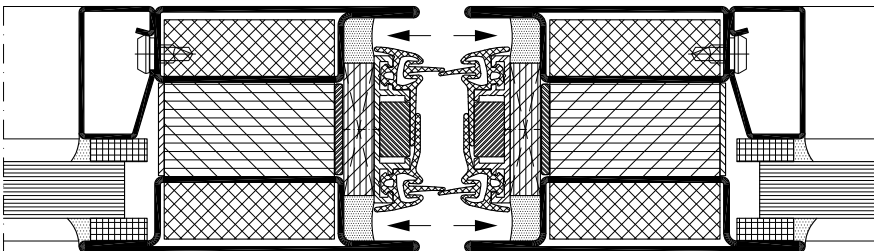

Processing according to processing manuals Forster fuego light.



Installation of sealing set NR Single action door frame 1 leaf door

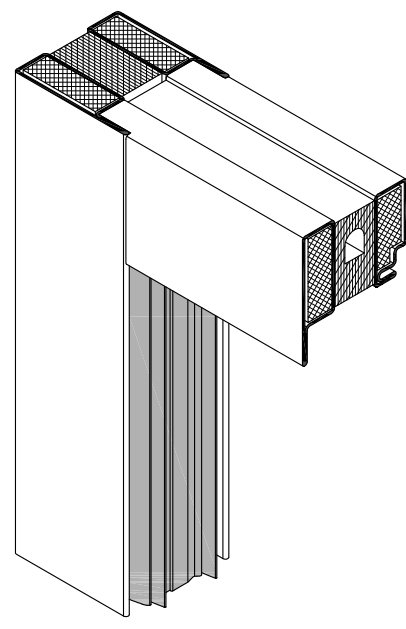
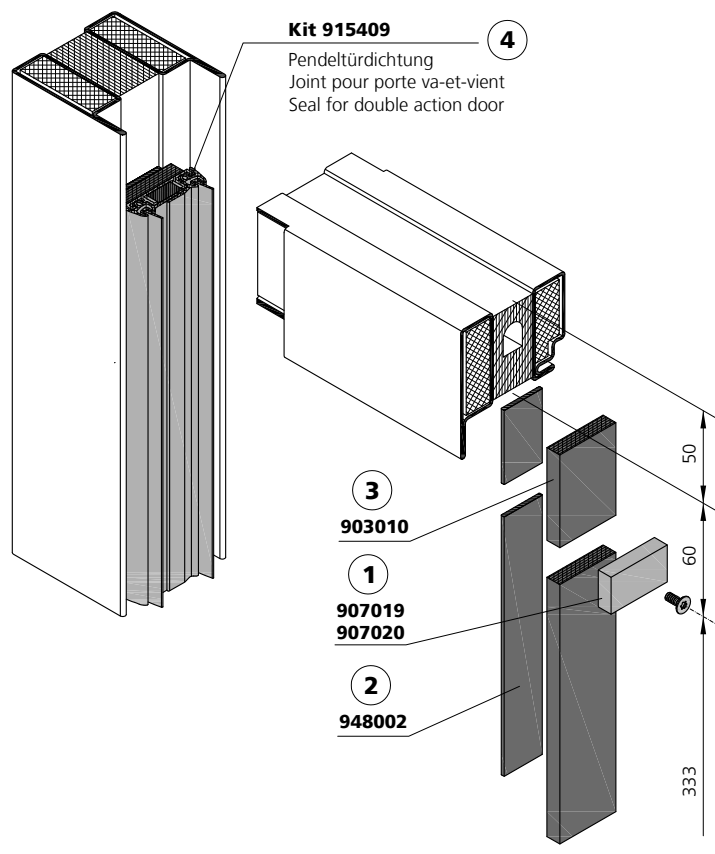
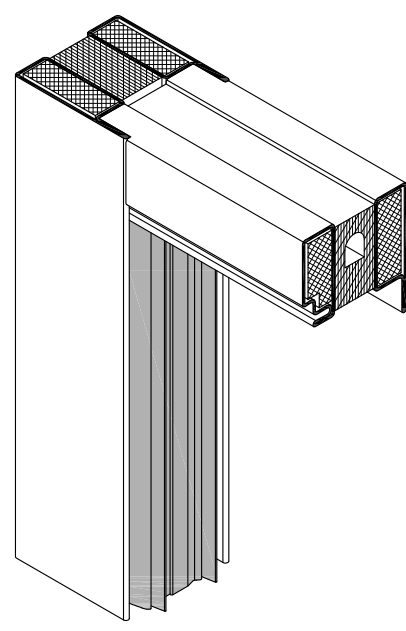
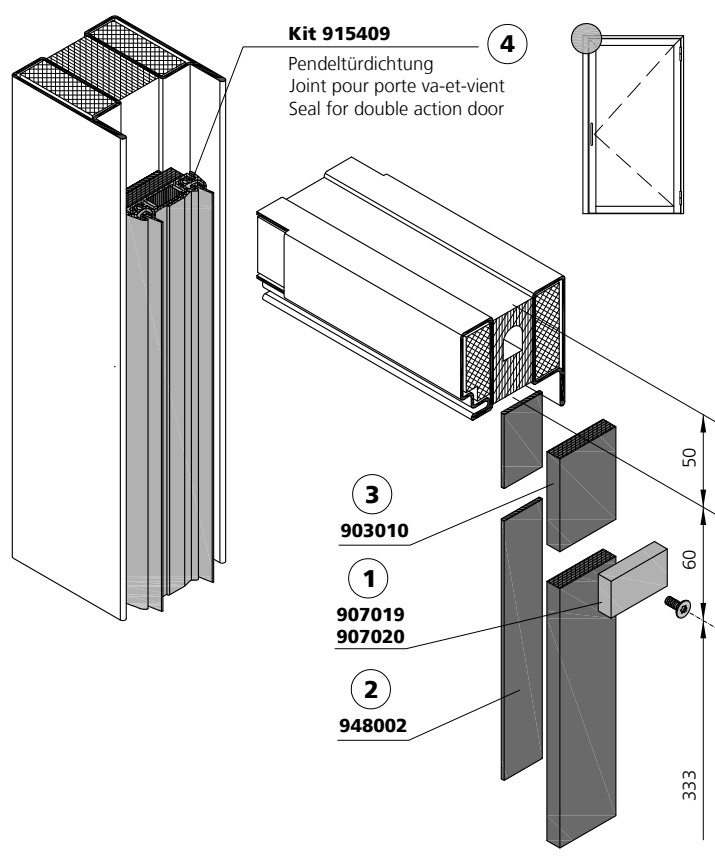



EI30/60

Steel

Stainless steel

UK

16

Installation of sealing set NR Single action door leaf Opening outwards - 1 and 2 leaf door

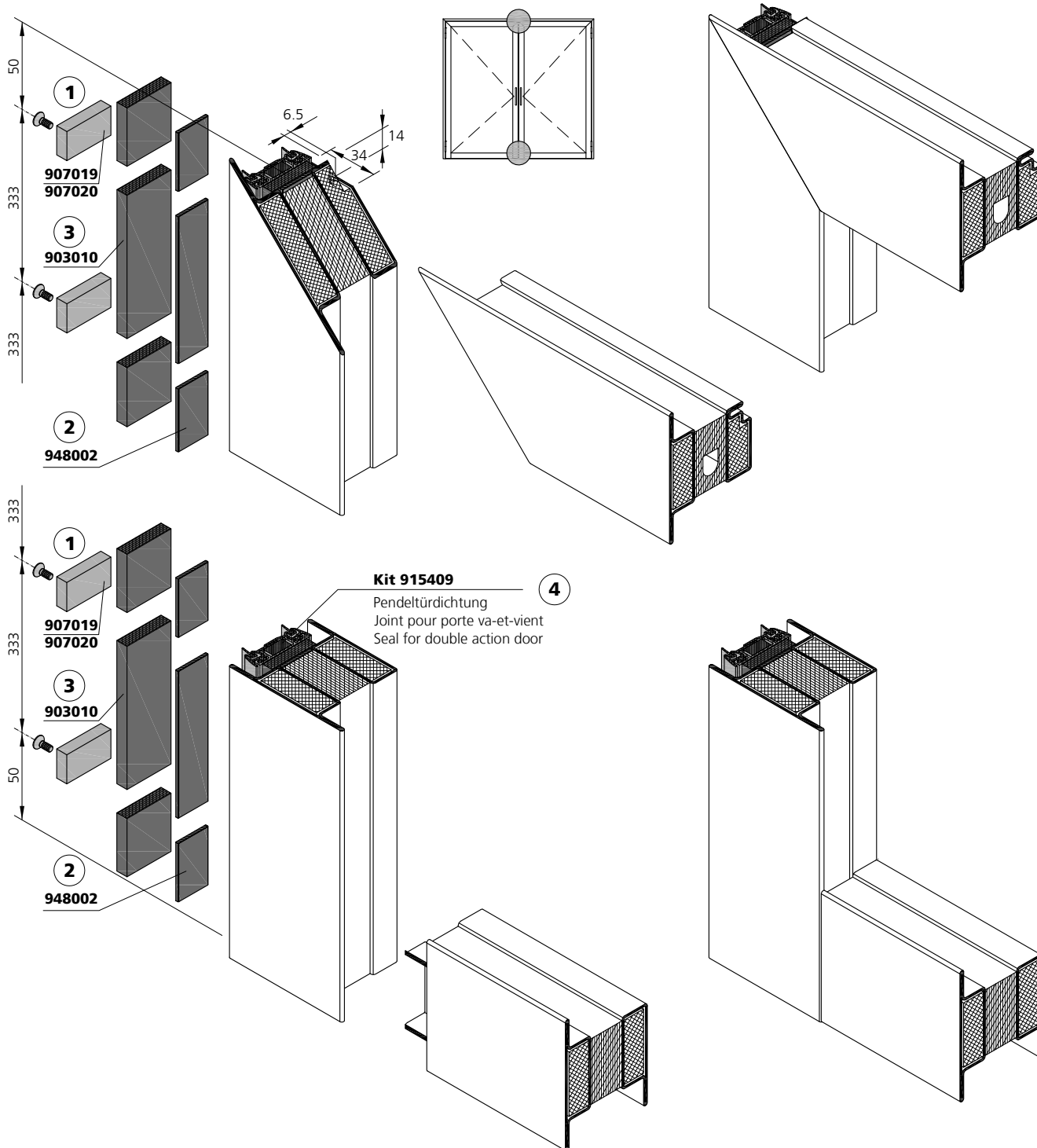

10/16



Installation of sealing set NR Single action door leaf Opening inwards – 1 and 2 leaf door

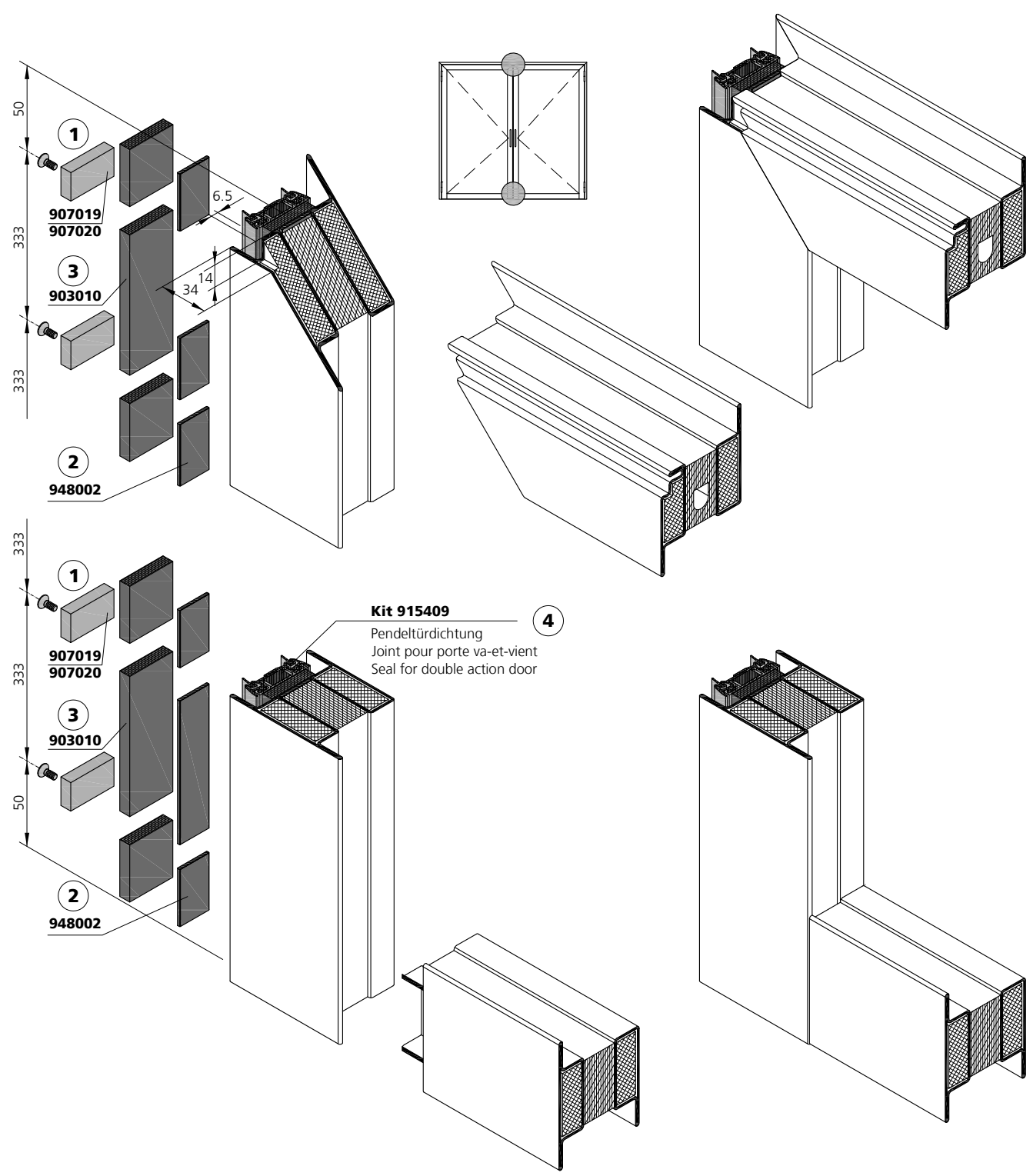

General advice

Forster's series of profiled steel sections and the corresponding accessories have been developed for a wide range of applications in the manufacture of metal structures and façades. These series are designed for processing by specialist firms in the metal-working industry, window construction and similar, who are familiar with the appropriate technical standards, particularly in the field of metal working, door, window and façade construction and where an adequate knowledge of all relevant standards, directives and suppliers' processing instructions can safely be assumed.

All the documentation published by us concerning the combination, erection, arrangement, processing, refinement and assembly of the articles on offer are voluntary services intended as suggestions and ideas for the expert, or else represent a report on combinations and installations already assembled. In all cases when using this documentation, the expert must always critically study whether the suggestions and ideas are suitable and appropriate for the case in point, since loads and stresses vary so greatly that it is impossible in this kind of documentation to cover every eventuality occurring in practice.

Technical support in planning and project work

Free of charge technical consultation during planning and project preparation does not form part of our quotation or contract of sale as either a primary or secondary obligation. Forster Profile Systems Ltd. has no intention to create legal relations in this regard.

All ideas, suggestions for tender, design and installation, static calculations, material calculations, etc. provided within the context of consultation and discussion, in the form of sketches, drawings, correspondence or plans drawn up by our employees are made to the best of our knowledge and ability and shall be considered a free of charge service without any obligation for which we do not accept any liability. The responsibility for the planning lies at all times exclusively with the builder and architect. On-site plans will not be verified by Forster Profile Systems Ltd.

A separate consultancy contract involving payment must be concluded in the written form if information of a binding nature is required, especially with regard to the installation of the elements and the building physics involved in problems such as static calculations, fastenings, thermal insulation, waterproofing, fire, smoke and sound protection, etc. or to the installation of components from other manufacturers in the façades or metal structures from Forster Profile Systems Ltd.

Warranty

Unless a written agreement on the contrary has been concluded, the warranty granted by Forster Profile Systems Ltd. applies solely to the extent of the "General Conditions of Sale and Delivery of Forster Profile Systems Ltd." with which the customer is already familiar.

In all cases the warranty only applies provided that original construction parts (profiles, accessories, fittings) are used from the currently valid Forster range. All liability is declined for any damage arising from the use of articles other than Forster original articles. If articles other than Forster original articles are used, test certificates and attestations granted to Foster for constructions built using such articles are deemed to be invalid.

Note

The up-to-dateness, completeness or quality of the contents are not guaranteed. We reserve the right to make technical alterations in the content wholly or partially with no prior notice. We are not liable for damages of any kind, which arise from the use of the information in this document or on the basis of its incompleteness.

The non-observance of the information on the home page of the manufacturer which is currently retrievable, specific for the product, as well as general, in particular with regard to the use for the purpose intended, safety regulations, product performance, product maintenance as well as the duty to inform and instruct, releases the manufacturer from his liability for his product.



UK



Profilsysteme in Stahl und Edelstahl

Systèmes de profilés en acier et en acier inox

Steel and stainless steel profile systems

Fassaden / Façades / Curtain walls

forsterthermfix[®]vario

forsterthermfix[®]light

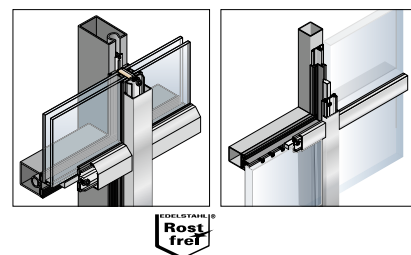

Fenster / Fenêtres / Windows

forsterunico[®]

forsterunico[®]XS

forsterunico[®]Hⁱ

forsterunico[®]XS Hⁱ

forsternorm[®]

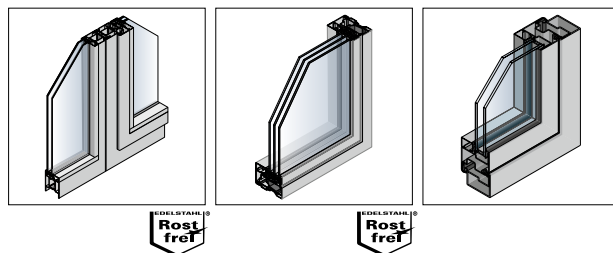

Türen / Portes / Doors

forsterunico[®]

forsterunico[®]Hⁱ

forsterpresto[®]

forsternorm[®]

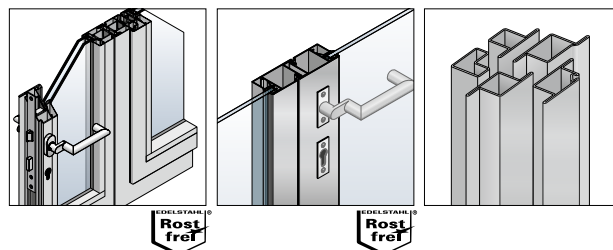

Brand- und Rauchschutz / Coupe-feu et pare-flamme / Fire and smoke protection

forsterfuego[®]light

forsterpresto[®]

forsterthermfix[®]vario

forsterthermfix[®]light

forsterunico[®]

